

Kit for spacers between elements

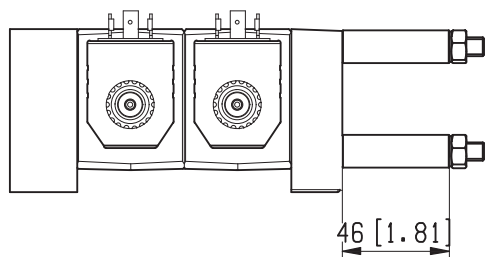

The spacers (code 44-00257012) are fitted in order to install longer tie-rods for future insertion of an extra directional element.

Flow restrictor

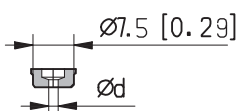

Material description	Orifice I.D. mm [inch]	Material Number
50-04999	Closed	R933002917
50-05003	0,3 [0.012]	R933002922
50-05004	0,4 [0.016]	R933003398
50-05001	0,5 [0.020]	R933002920
50-05000	0,6 [0.024]	R933002919
50-05002	0,7 [0.028]	R933002921
50-0500	0,8 [0.031]	R933002918
50-05008	0,9 [0.035]	R933002923
50-0501	1,0 [0.039]	R933002924
50-05015	1,1 [0.043]	R933002925
50-0502	1,2 [0.047]	R933002926
50-05022	1,35 [0.053]	R933002927
50-0503	1,5 [0.059]	R933002928
50-05032	1,6 [0.063]	R933002930
50-05031	1,7 [0.067]	R933002929
50-0504	2,0 [0.079]	R933002931
50-0505	2,2 [0.087]	R933002933
50-05045	2,5 [0.098]	R933002932
50-0506	3,0 [0.118]	R933002934
50-0508	3,2 [0.126]	R933002935

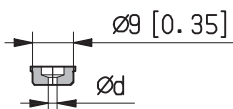

Material description	Orifice I.D. mm [inch]	Material Number
50-07000	Closed	R933002936
50-07020	0,8 [0.031]	R933002937
50-07021	1,0 [0.039]	R933007090
50-07030	1,6 [0.063]	R933002938
50-07031	1,7 [0.067]	R933007091
50-07040	2,0 [0.079]	R933002939
50-07047	2,75 [0.108]	R933002940
50-07050	3,0 [0.118]	R933002941