

Technical data	
Max. pressure	350 bar
P1 max. flow	80 lpm *
P2 max. flow	40 lpm *
Weight	8,3 Kg
Manifold material	Steel
M1 / M2 ports	1/4" G
P2/ P2 ports	1/2" G
P1/ P1 / A / B ports	3/4" G
T port	1" G
* The sum of the two pumps must not exceed 100 lpm.	

Dimensions in mm

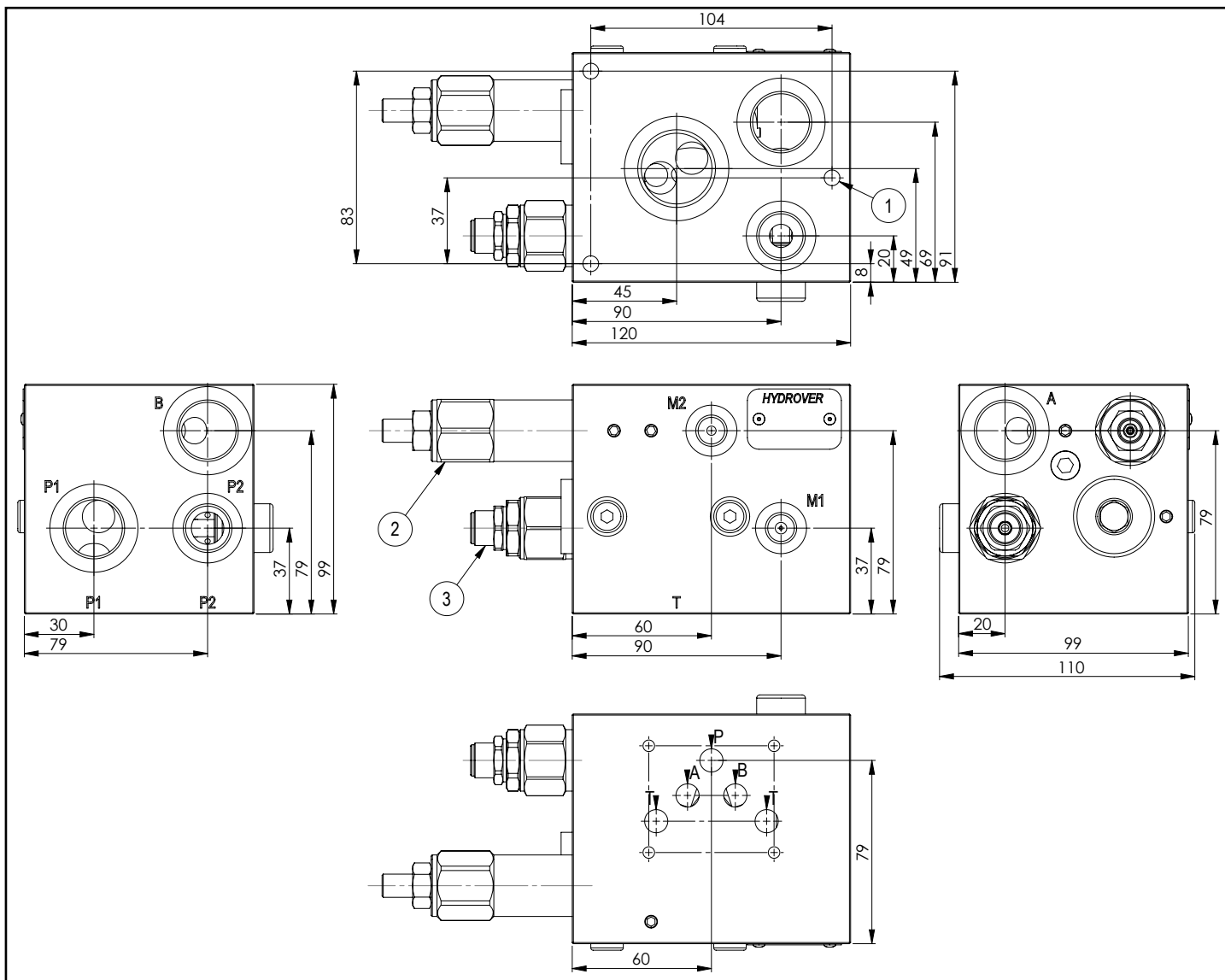

N°	Description	Q.ty
1	M8x12 for mounting	3
2	Cutoff valve 20-180 bar	1
3	Bosch Rexroth relief valve VMD1.040 *	2

* for complete technical information, click on the blue link or go to the components section at the end of the catalogue

Ordering code

H	9	7	0	3	9	S	-	-	-
---	---	---	---	---	---	---	---	---	---

Hydrover product

Product series

97 series - Multifunctional integrated circuits

Product ID

Manifold material

Steel

Relief valve adjustment pressure range

- 1 = 25-120 bar
- 2 = 40-200 bar
- 3 = 200-350 bar

Relief valve adjustment type

S = Screw

